



## OWNER'S MANUAL MHR300 Metal Hose Reel

### TOOLS REQUIRED

- Flat head screw driver
- Adjustable wrench and/ or pliers

NOTE: Do not completely tighten screws until the assembly is complete. For easier assembly, we recommend that two people assemble this product.

### CAUTION

- Always release water pressure by leaving the hose nozzle OPEN when not in use.
- Be sure to have the water turned OFF and the nozzle OPEN before removing reel from mounting and also when rewinding hose.
- Do not inflate tires more than 30 psi.

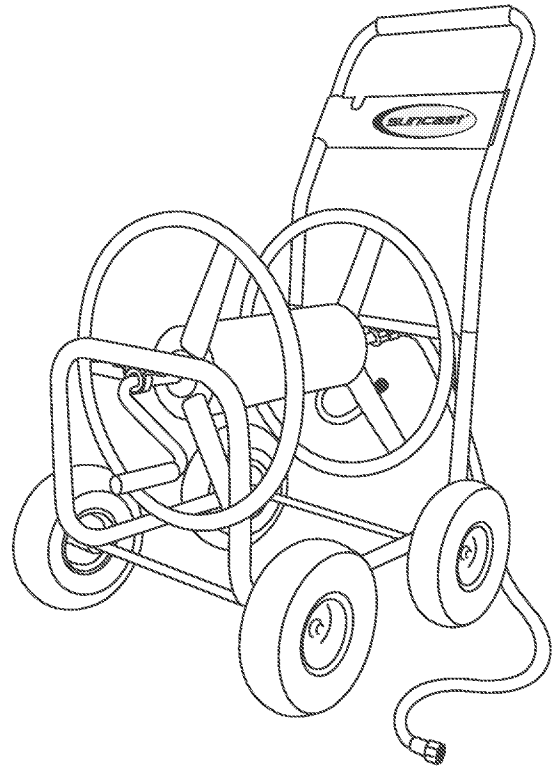

## Before you begin...

**This product has been packaged to assure it arrives in the best possible condition.** Please be careful not to scratch product when unpacking.

**Read instructions prior to assembly.** This kit contains parts that can be damaged if incorrectly assembled.

**Please follow instructions.** Suncast is not responsible for replacing parts damaged due to incorrect assembly.

## MHR300 Warranty

Suncast® Corporation, 701 North Kirk Road, Batavia, Illinois 60510 (manufacturer) warrants to the original purchaser only that the enclosed hose reel is free from material and workmanship defects under normal household use at date of purchase. Defective product or part must be returned, freight prepaid, to Suncast Corp., 701 North Kirk Road, Batavia, IL 60510, Attention: Parts Department, along with the proof of purchase. Upon receipt of the aforesaid, the defective product or part will be repaired or replaced at the option of the manufacturer without charge to the original purchaser and returned to the customer freight collect.

This limited warranty does not apply to damage resulting from accident, neglect, misuse, commercial use, alteration, operation not in accordance with instruction, or repairs made or attempted by unauthorized persons.

This limited warranty applies only to the hose reel enclosed and does not apply to accessory parts.

THE MANUFACTURER'S LIABILITY HEREUNDER IS LIMITED SOLELY TO THE REPAIR OR REPLACEMENT OF THE DEFECTIVE PRODUCT OR PART AND THE MANUFACTURER SHALL IN NO EVENT BE LIABLE FOR ANY INCIDENTAL OR CONSEQUENTIAL DAMAGES THAT MAY RESULT FROM ANY DEFECT IN MATERIAL OR WORKMANSHIP FROM THE BREACH OF ANY EXPRESS OR IMPLIED WARRANTY.

Some states do not allow the exclusion or limitation of incidental or consequential damages, or a limitation of how long an implied warranty lasts, so the above limitations may not apply to you. This warranty gives you specific legal rights, and you may have other rights, which may vary from state to state.

## Assembly Instructions

Carefully remove all parts from the box and place on a smooth flat surface.

1. Remove the screw and washers from axle and insert axle (D) into axle brace on frame (A) of unit. Make sure the flat on the axle is oriented correctly with the flat in the axle hole.

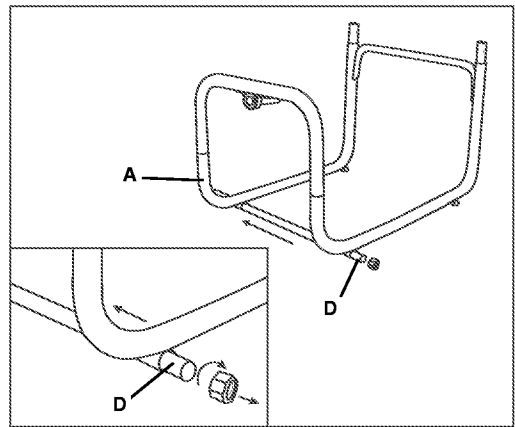

2. Slide wheels (E) with wheel hub to the inside and the tire stem to the outside onto the extended poles of both axles. Secure wheels and large washers with non-slip nut (H4) and tighten using enclosed wrench or adjustable wrench.

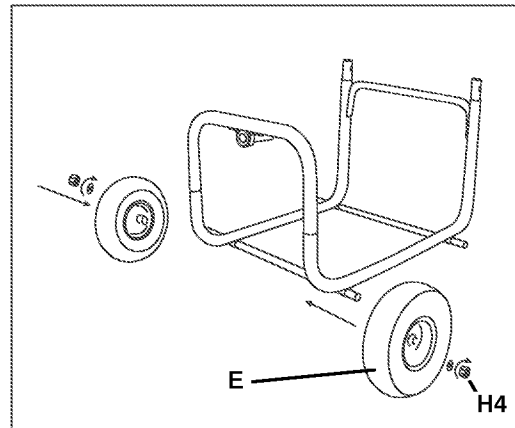

3. Insert crank stem (F) into crank hub.

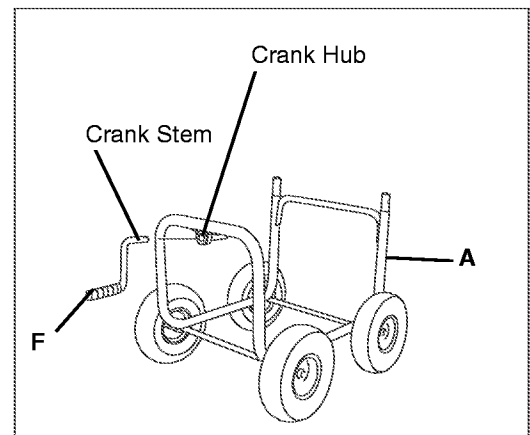

4. Place reel assembly (B) into reel frame (A) so that the reel assembly rests inside the reel frame.

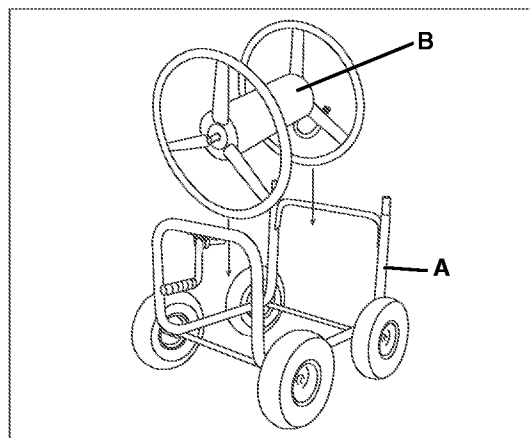

4. Insert reel assembly hub into crank stem and line up holes. Insert two carriage bolts (H3) from top and side of the crank hub and tighten using enclosed wrench or adjustable wrench.

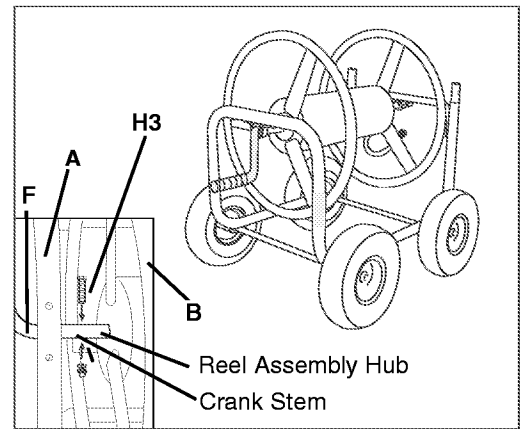

5. Assemble the coupling end of the reel frame by aligning the holes on the U shaped bracket with the holes on the frame. Insert one 30mm screw per hole and secure with one washer and one lock nut (H2). Tighten securely.

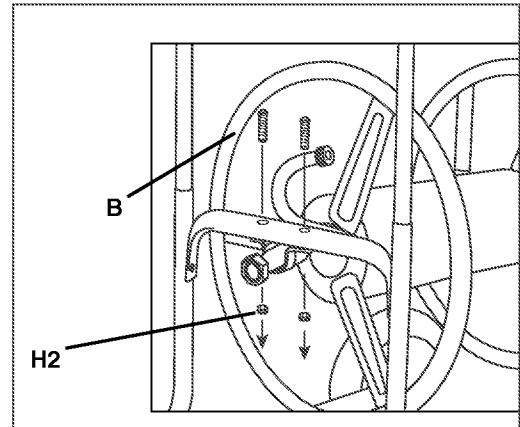

6. Slide the handle (C) on to the vertical posts located on the frame (A) and align the holes. Secure the handle using 45mm screw, washer and nut (H1).

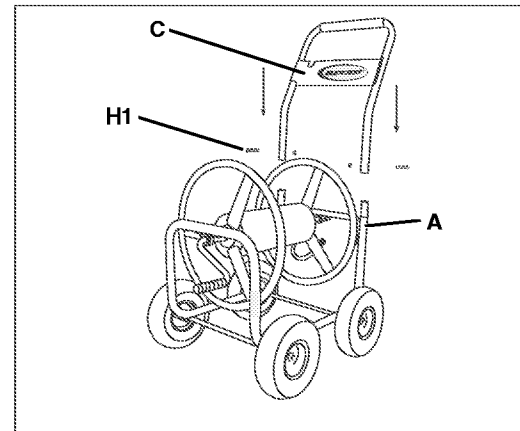

7. Insert one rubber washer into female swivel coupling on the reel assembly (B), then connect the male end of leader hose (G).

Attach garden hose to threaded water supply-tube and wind onto reel.

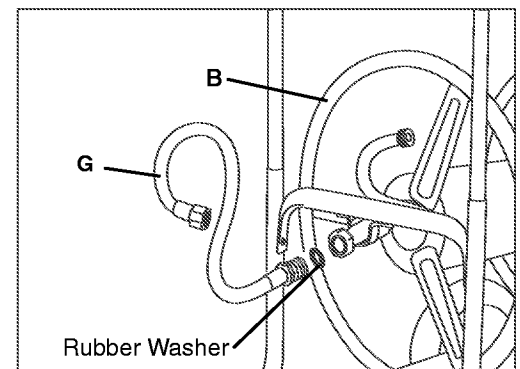

Please provide this information.

Name \_\_\_\_\_  
 Street \_\_\_\_\_ City \_\_\_\_\_  
 State \_\_\_\_\_ Zip Code \_\_\_\_\_  
 Phone \_\_\_\_\_ Date \_\_\_\_\_

Place of Purchase

## MHR300

### Ordering Instructions

1. Call Suncast for pricing information call 800-846-2345 or 630-879-2050. Monday - Friday 8:00 am - 4:30 pm Central Time. (Except holidays) Or see [www.suncast.com](http://www.suncast.com)
2. Completely fill out address. Print Clearly.
3. Add Shipping and Handling to Total Cost. (Illinois residents add 6.75% sales tax.)
4. Send complete form with check or money order to Suncast Corp.
5. No C.O.D. Orders will be accepted.

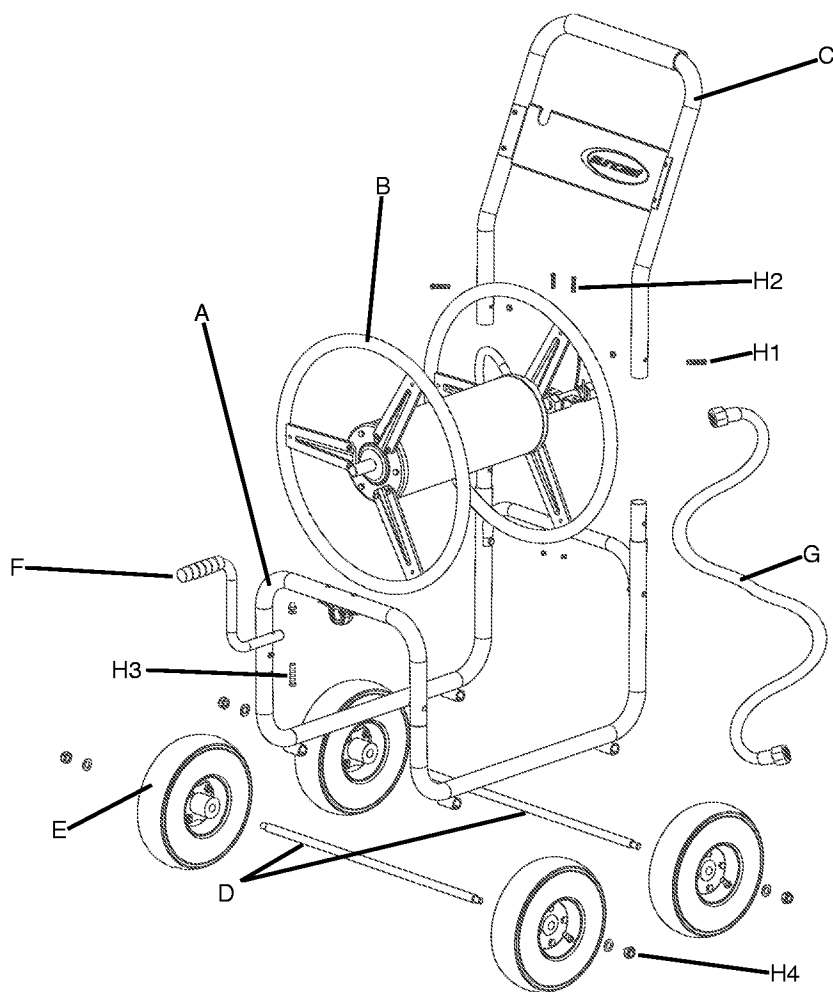

For  
 information on  
 Suncast products and  
 replacement parts see  
[www.suncast.com](http://www.suncast.com)

**SUNCAST**

Index No.	Part Name	Part No	Cost Each	Qty. Ord.	Total Cost
A	FRAME				
B	REEL				
C	HANDLE				
D	AXLE (2)				
E	2 PLY PNEUMATIC TIRE (4)				
F	CRANK				
G	LEADER HOSE				
H1	45MM SCREW AND NUT (2)				
H2	30MM SCREW AND NUT (2)				
H3	40MM CARRIAGE BOLT AND NUT (2)				
H4	NON-SLIP NUT AND WASHER (4)				
SUB TOTAL:					
IL RESIDENTS ADD 6.75% TAX					
SHIPPING & HANDLING					
TOTAL:					
<input type="checkbox"/> CHECK ENCLOSED <input type="checkbox"/> MONEY ORDER ENCLOSED					

Mail To: Suncast Corporation 701 NORTH KIRK ROAD • BATAVIA, IL, USA 60510  
[www.suncast.com](http://www.suncast.com)

### PATENTS

Patents pending.

Made in China